

# S.P. n° 148 - DISSESTO IN PROSSIMITA' DEL VIADOTTO CROCELLE REALIZZAZIONE MURO SU PARATIA IN C.A.

SEZIONE

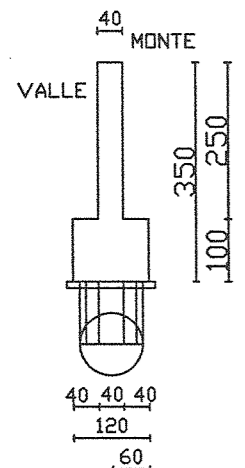

N=26 I[m]=1,60 D[cm]=100 L[m]=15,00

PROSPETTO

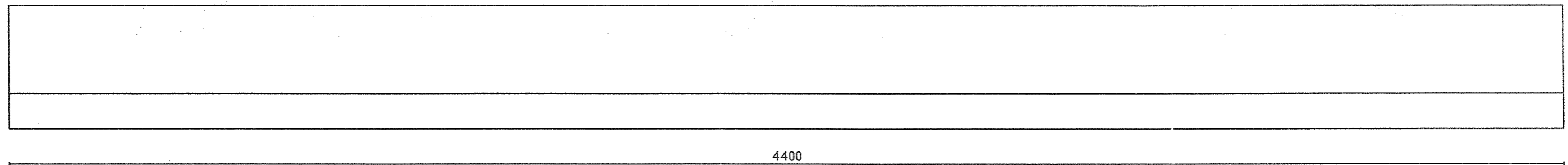

PIANTA

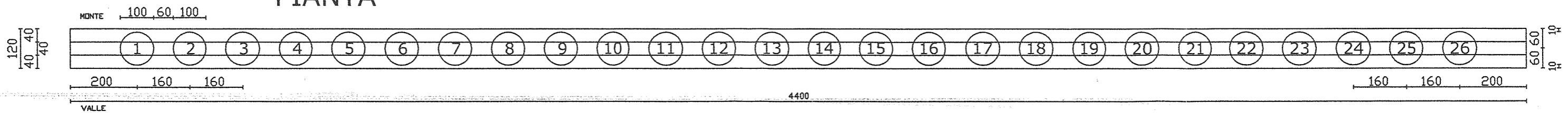

# S.P. n° 148 - DISSESTO IN PROSSIMITA' DEL VIADOTTO CROCELLE REALIZZAZIONE MURO SU PARATIA IN C.A. - ARMATURE

MURO E CORDOLO IN C.A.

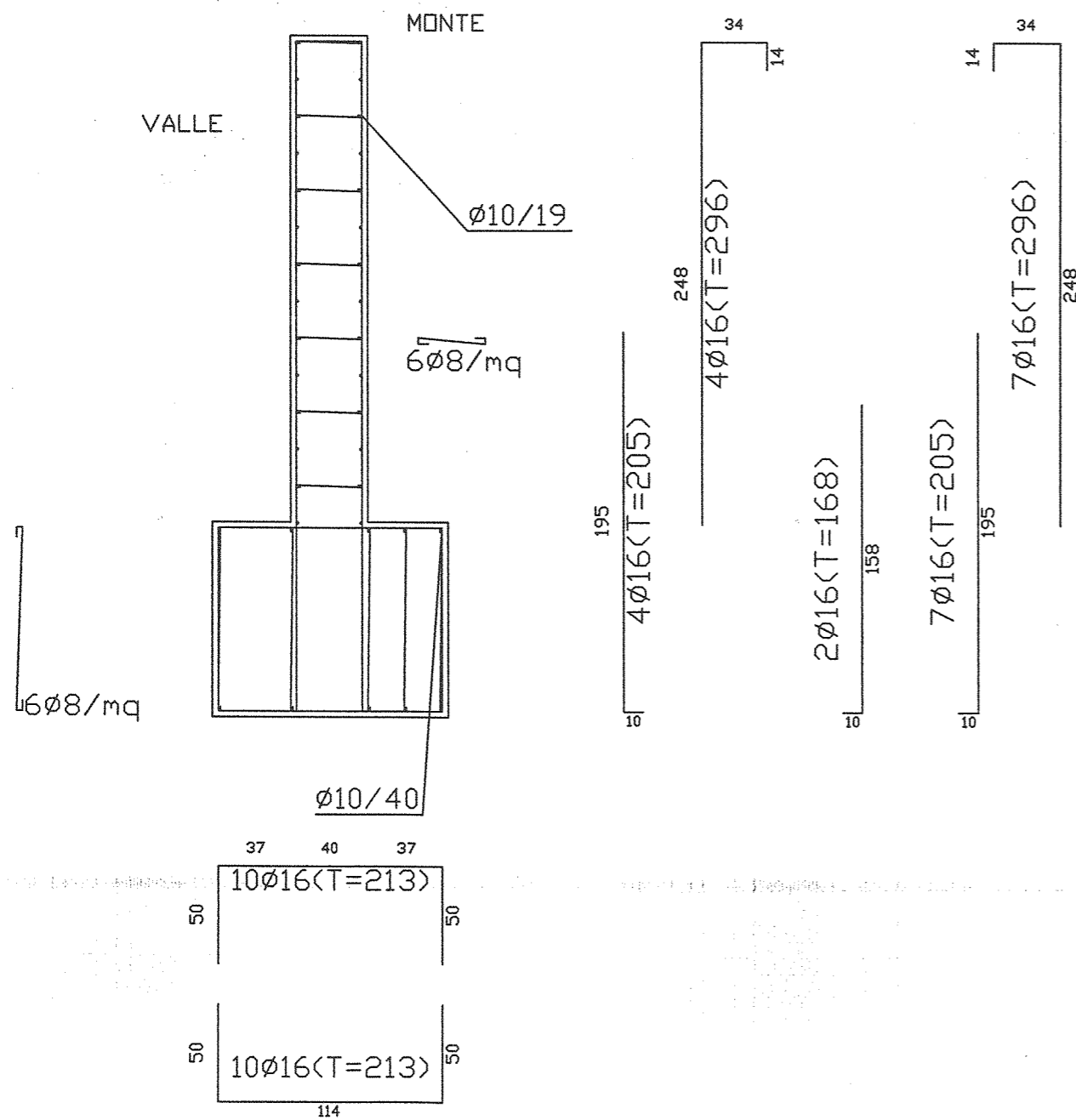

PALO IN C.A.

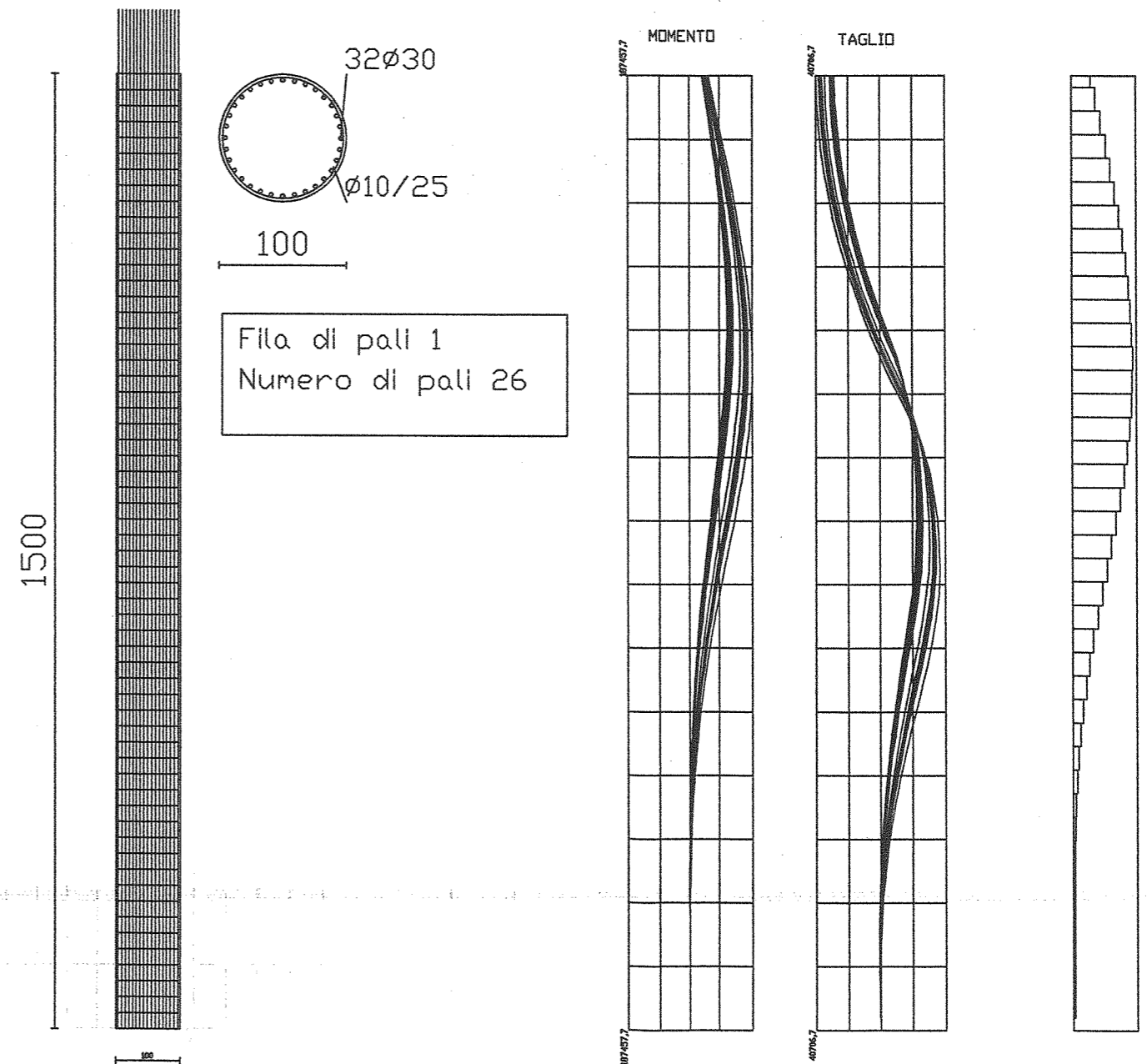

# S.P. n° 148 - DISSESTO IN PROSSIMITA' DEL VIADOTTO CROCELLE REALIZZAZIONE MURO SU PARATIA IN C.A. - DIAGRAMMI

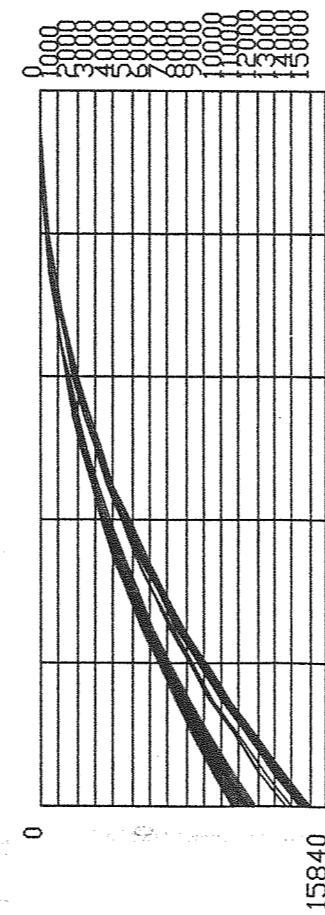
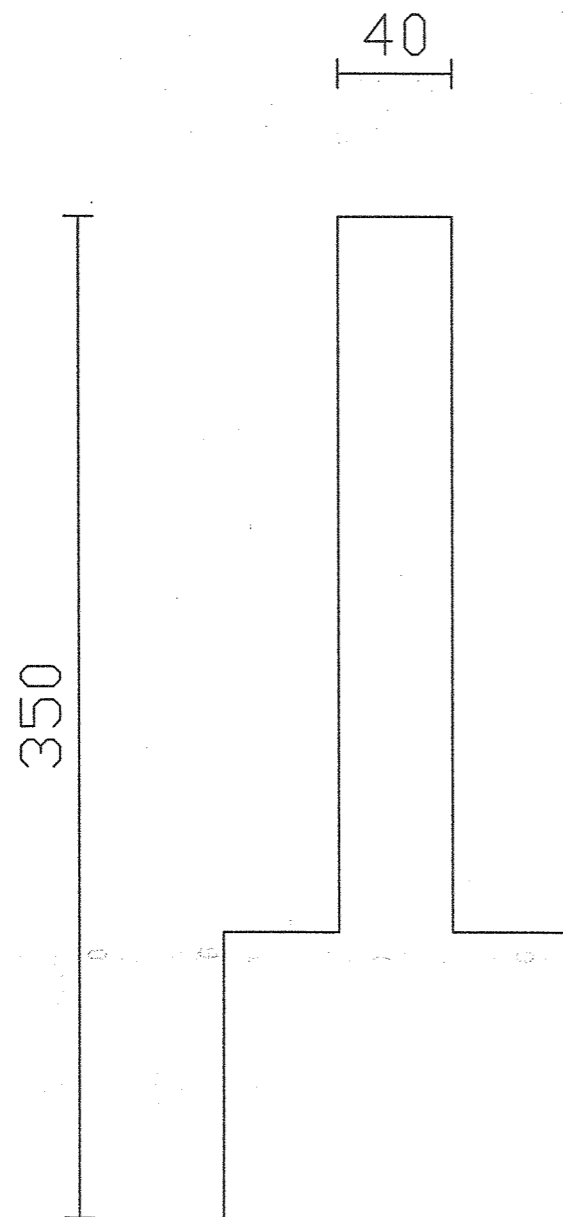
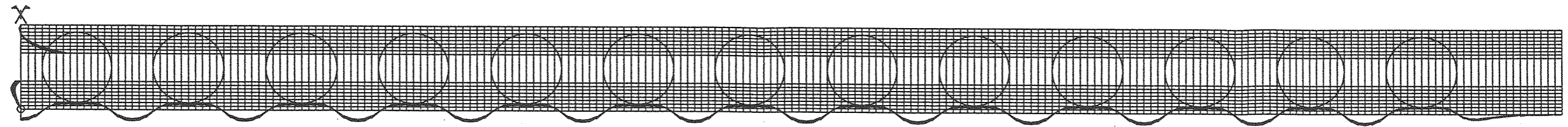

Momenti [kgm]

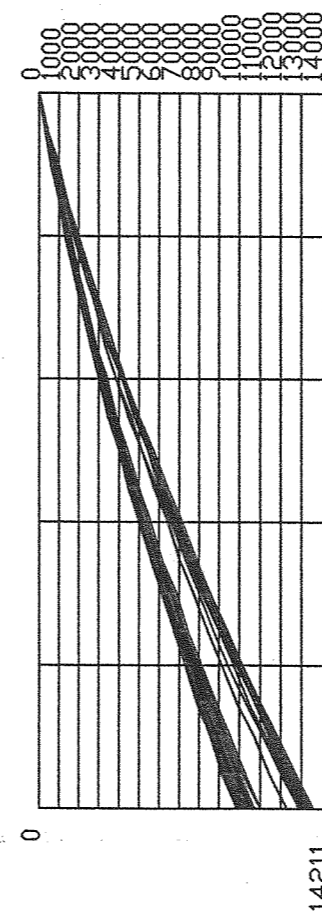

Taglio [kg]

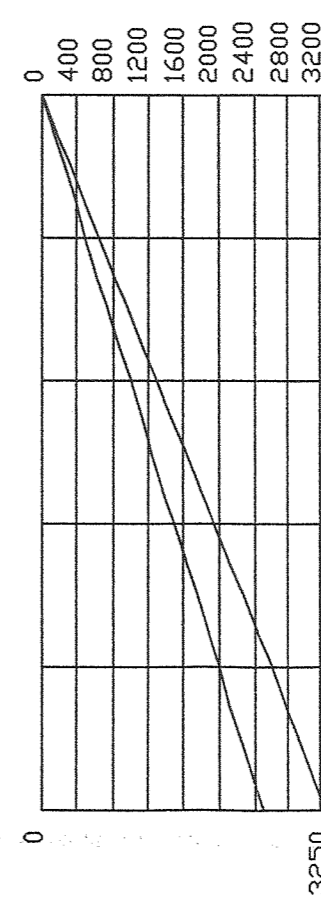

Sforzo Normale [kg]

S.P. n° 148 - DISSESTO IN PROSSIMITA' DEL VIADOTTO CROCELLE  
REALIZZAZIONE MURO SU PARATIA IN C.A. - PROFILO

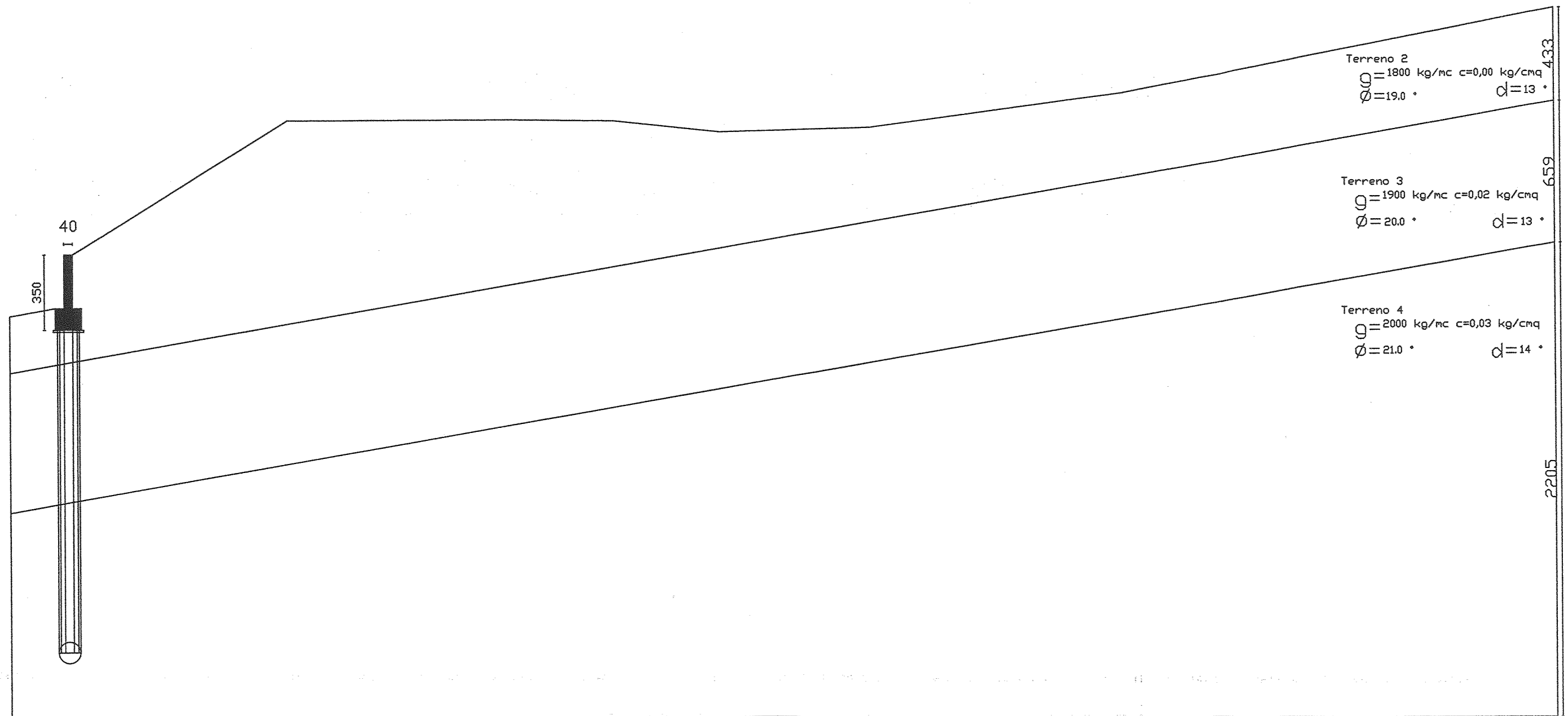

# S.P. n° 148 - DISSESTO IN PROSSIMITA' DEL VIADOTTO CROCELLE REALIZZAZIONE MURO D'ALA SU PARATIA IN C.A.

## SEZIONE

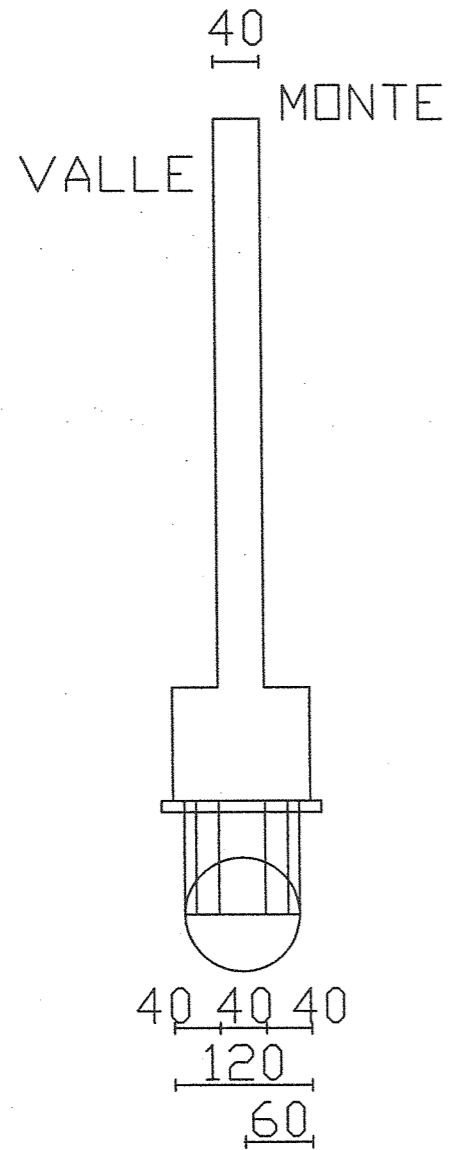

N=6 I[m]=1,50 D[cm]=100 L[m]=15,00

## PROSPETTO

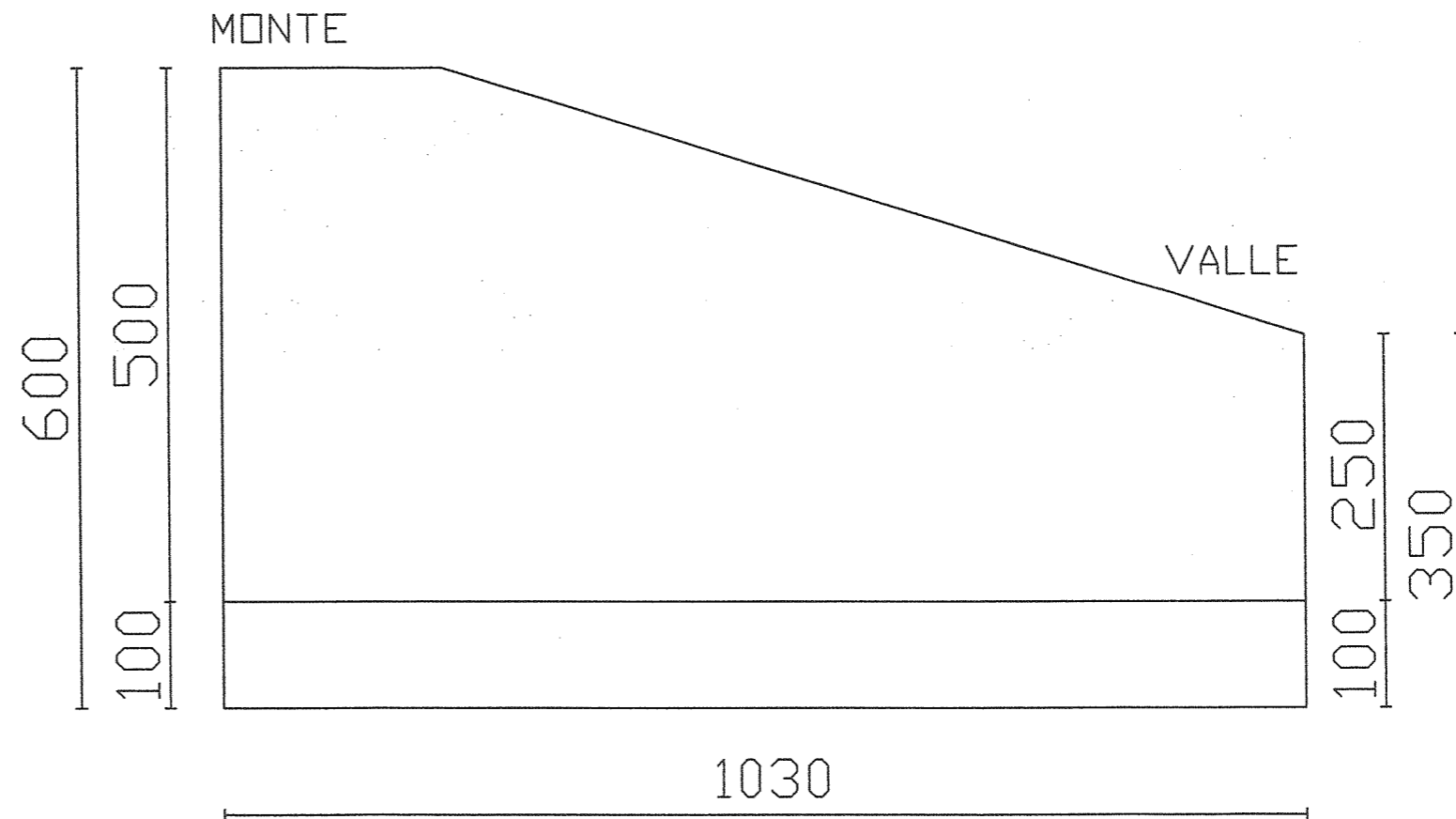

## PIANTA

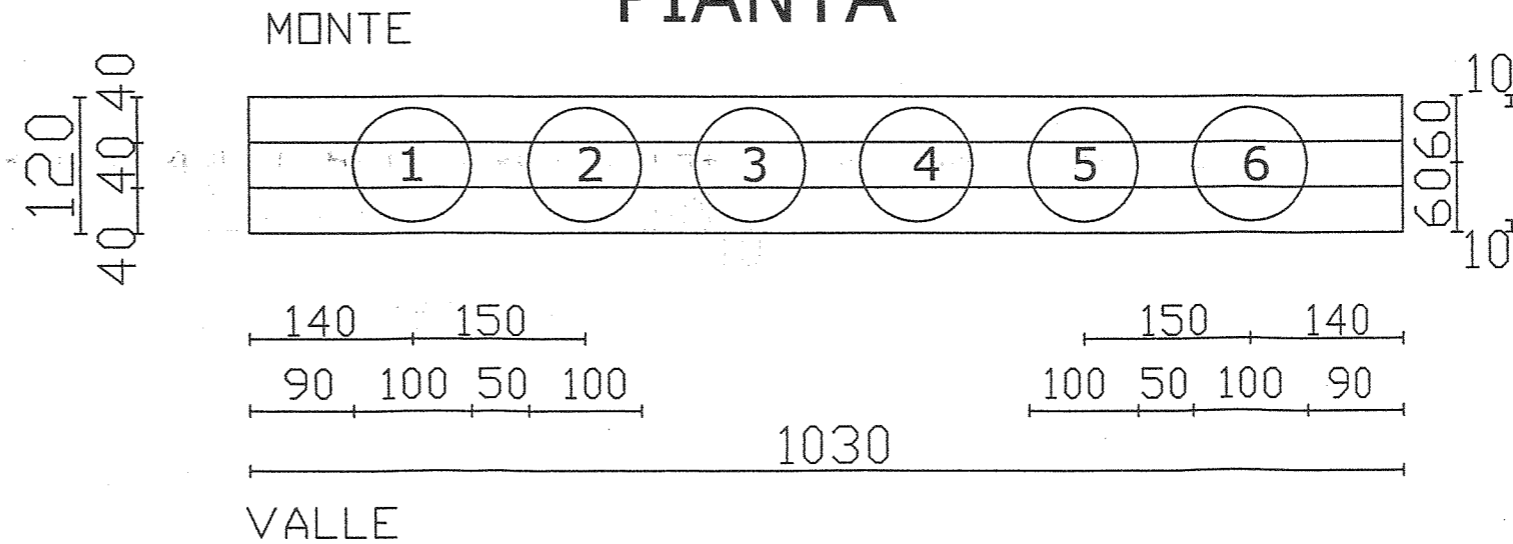

# S.P. n° 148 - DISSESTO IN PROSSIMITA' DEL VIADOTTO CROCELLE REALIZZAZIONE MURO SU PARATIA IN C.A. - ARMATURE

MURO E CORDOLO IN C.A.

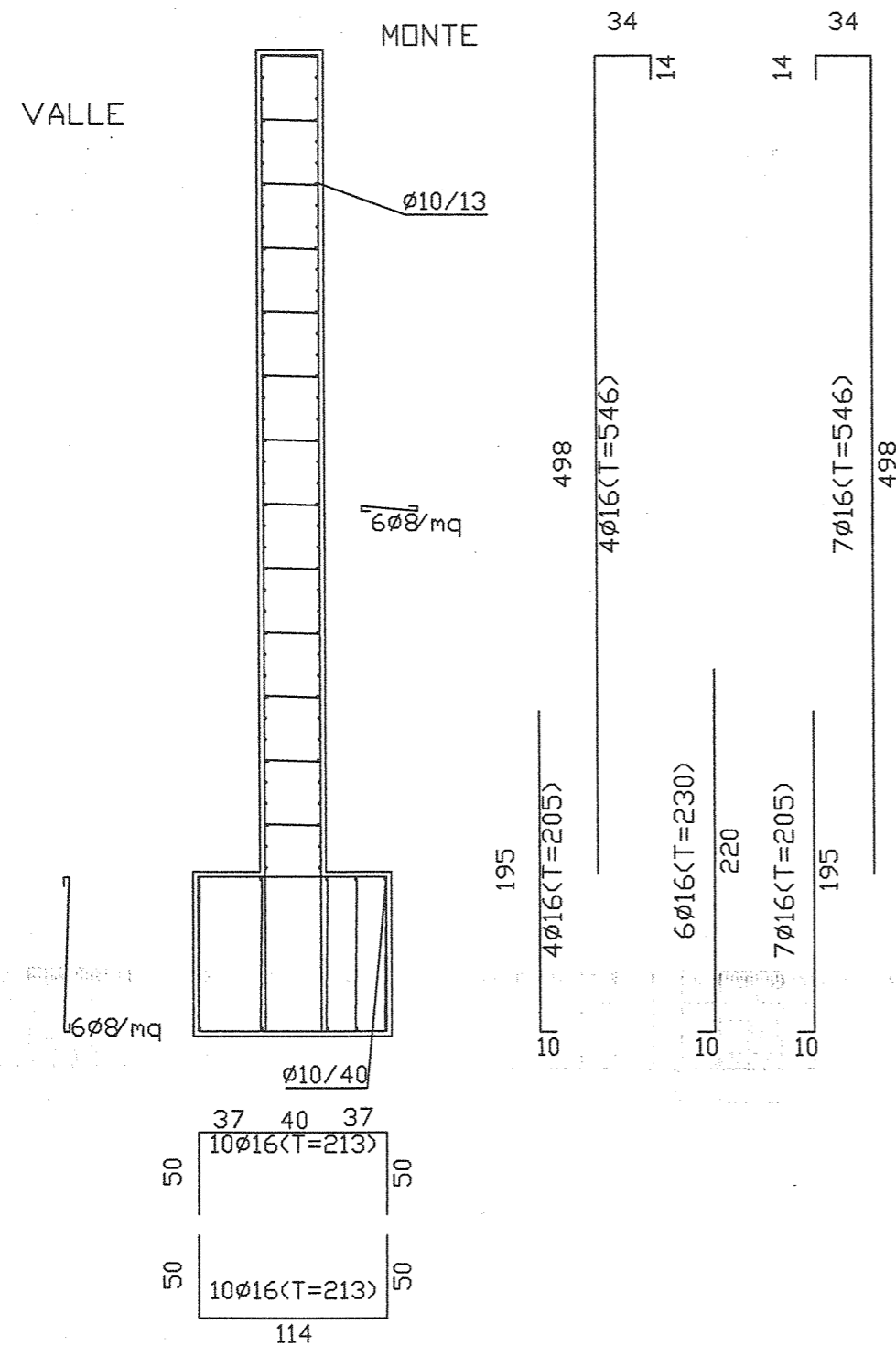

PALO IN C.A.

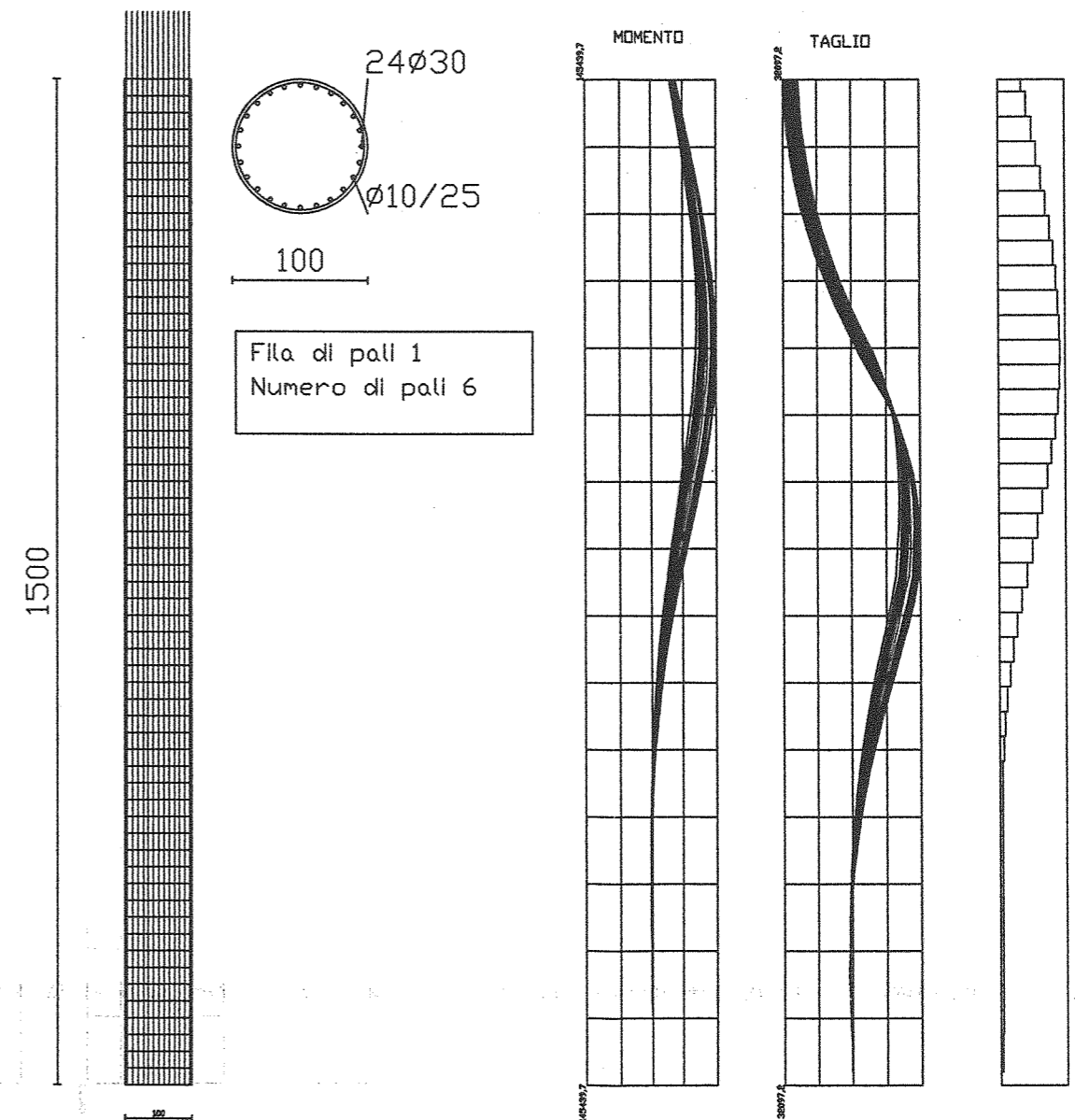

# S.P. n° 148 - DISSESTO IN PROSSIMITA' DEL VIADOTTO CROCELLE REALIZZAZIONE MURO D'ALA SU PARATIA IN C.A. - PROFILO

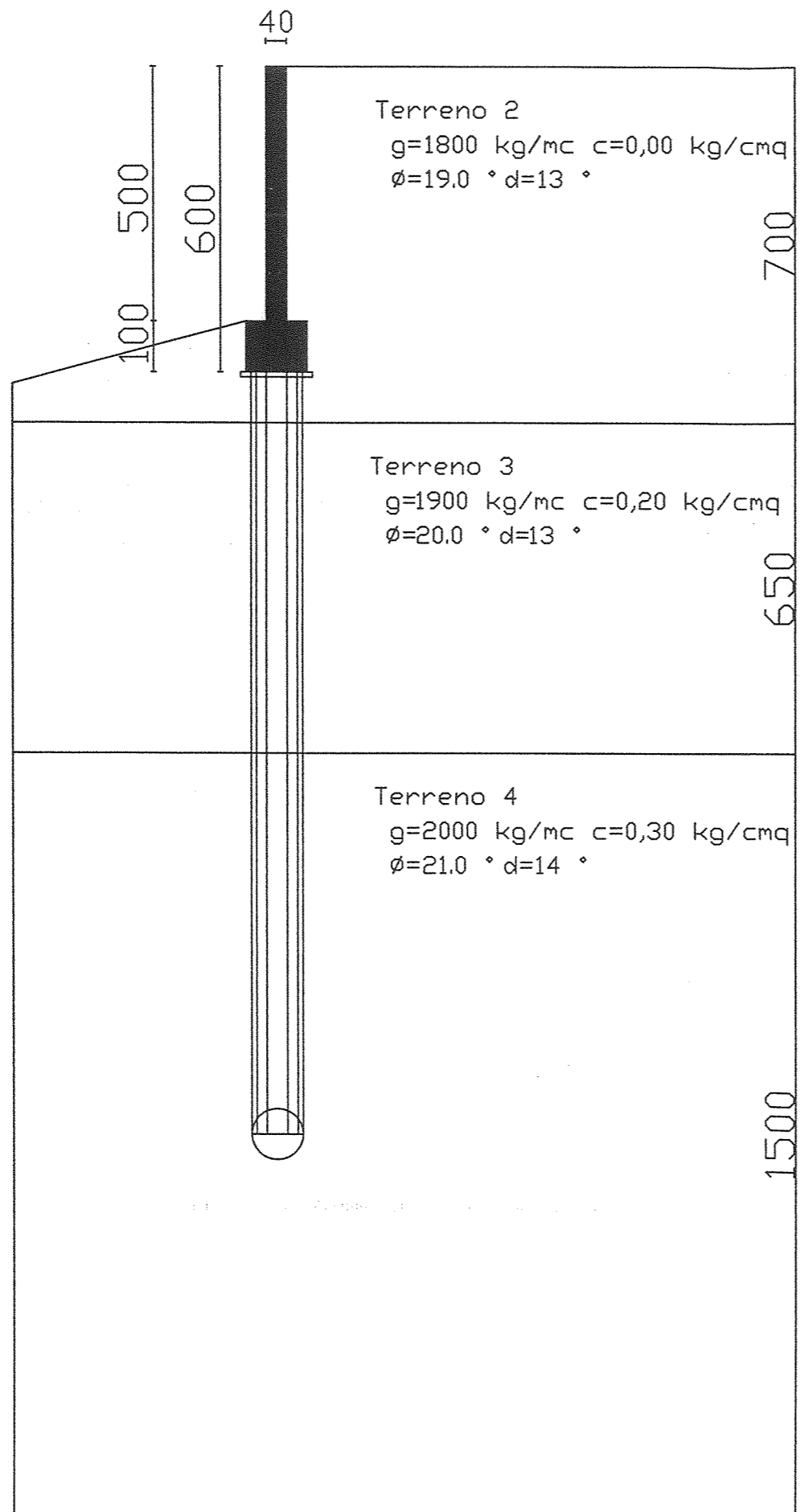

# S.P. n° 148 - DISSESTO IN PROSSIMITA' DEL VIADOTTO CROCELLE REALIZZAZIONE MURO SU PARATIA IN C.A. - DIAGRAMMI

